

# Pellet feeder

- easy to assemble
- laser-cut components (online available, e.g. Ponoko/ Formolor)
- Easily adjusted for different pellet-sizes
- pellets should be roundisch

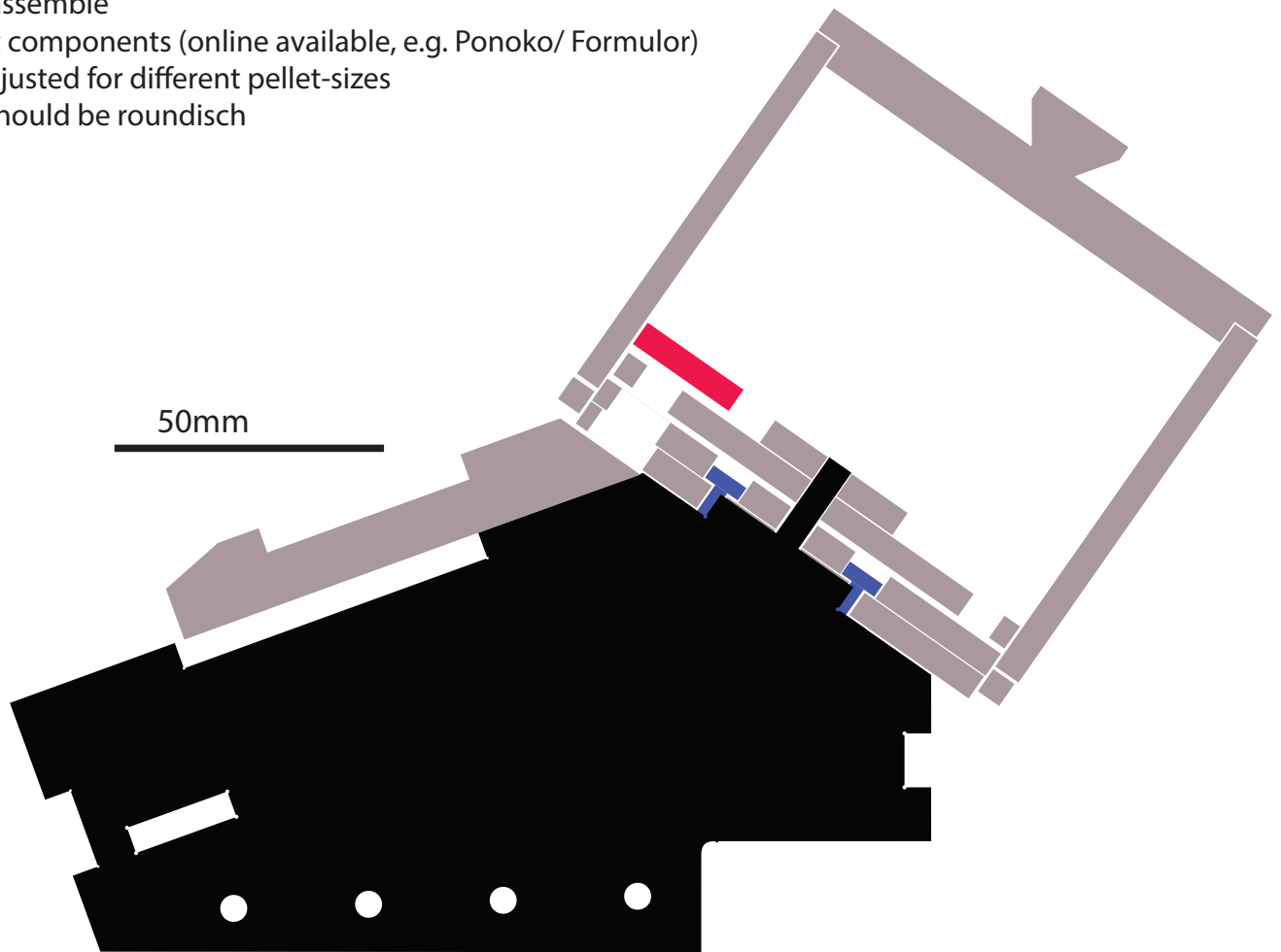

# Sketch, v3.3

Trinamic PD1141 / 1140

assumes kerf of 0.2 mm (mostly)

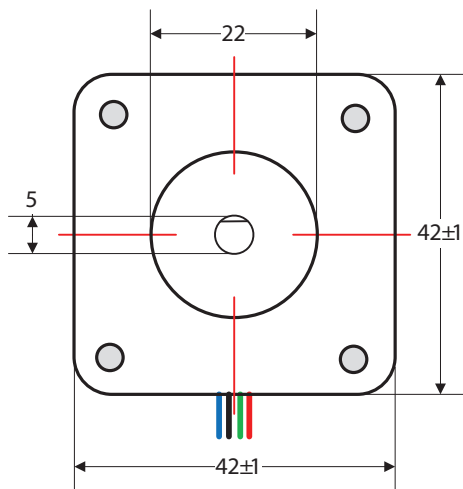
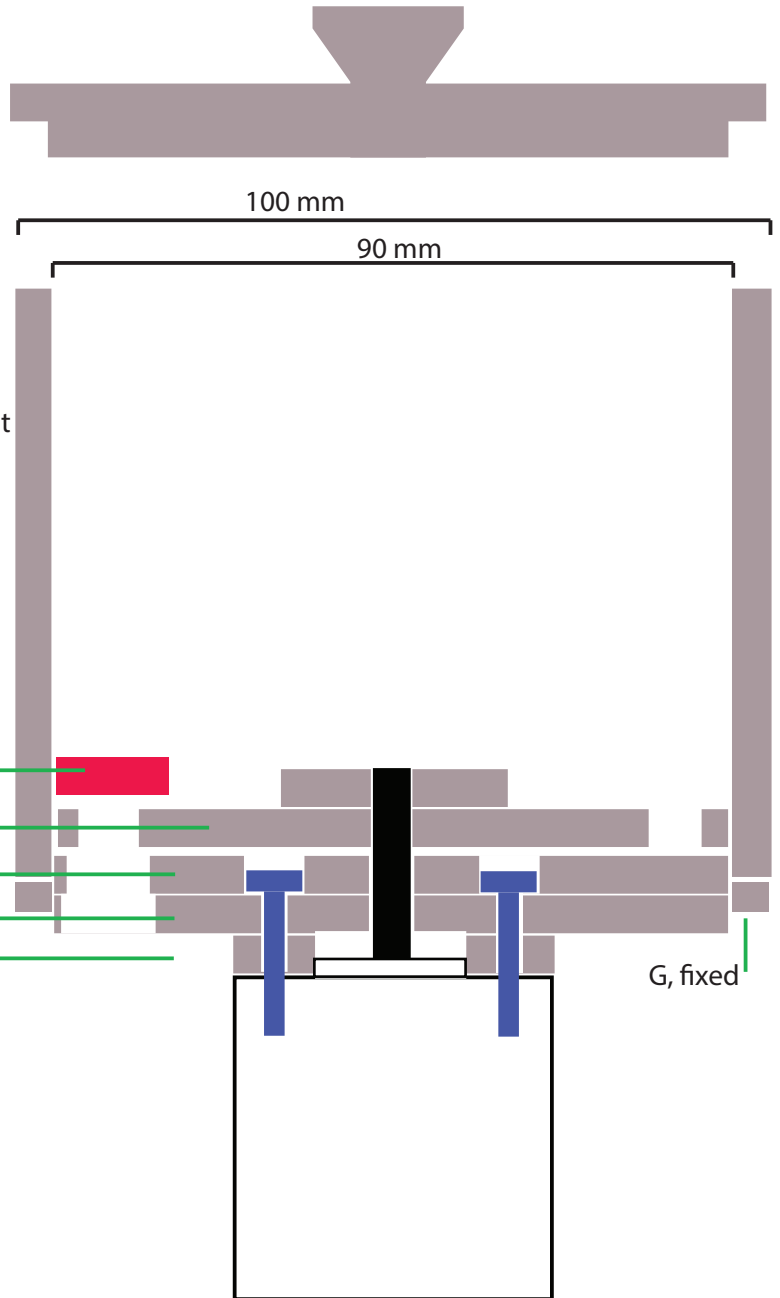
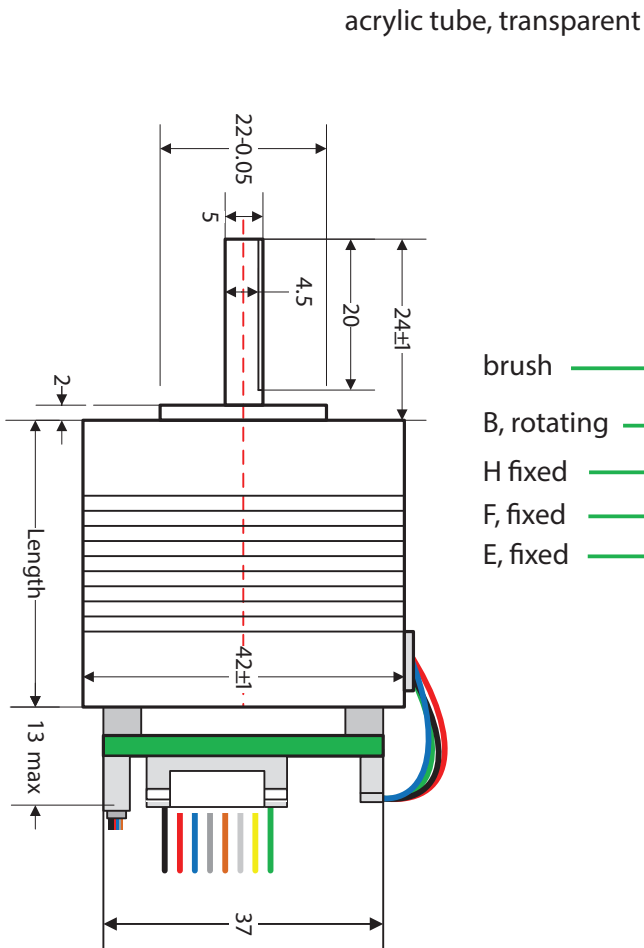

FRONT VIEW

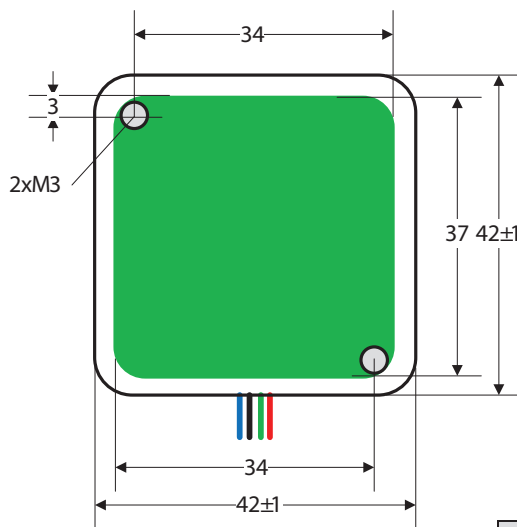

REAR VIEW

Model	Length of motor
PD42-1-1141	33.5±1 mm
PD42-2-1141	38±1 mm
PD42-3-1141	47±1 mm

# Components

Laser cut:

- 5.0 mm acrylic black
- 5.0 mm acrylic transparent
- Laser cut optional
- 3.0/ 4.0 mm acrylic for small pellets
- 5 mm acrylic transparent opaque to diffuse light

brush (Conrad: 189571 - 05)

screw (M4)

acrylic pipe (90mm inner, 100mm outer diameter) ~10cm long

piece of thin cardboard or paper as spacer between rotating disc and groundplate

Electronics

- socket (Conrad: 747422 - 05)
- circuit board (Conrad: 407827-05)
- LED-strip (Conrad: 184113 - 05)
- Motor (Conrad: 192812 - 05)

Tools etc.

- glue (Dichormethane, be very careful potentially carcinogenic = gloves, fume hood)
- glass pipette to apply glue to joints
- 4mm tap

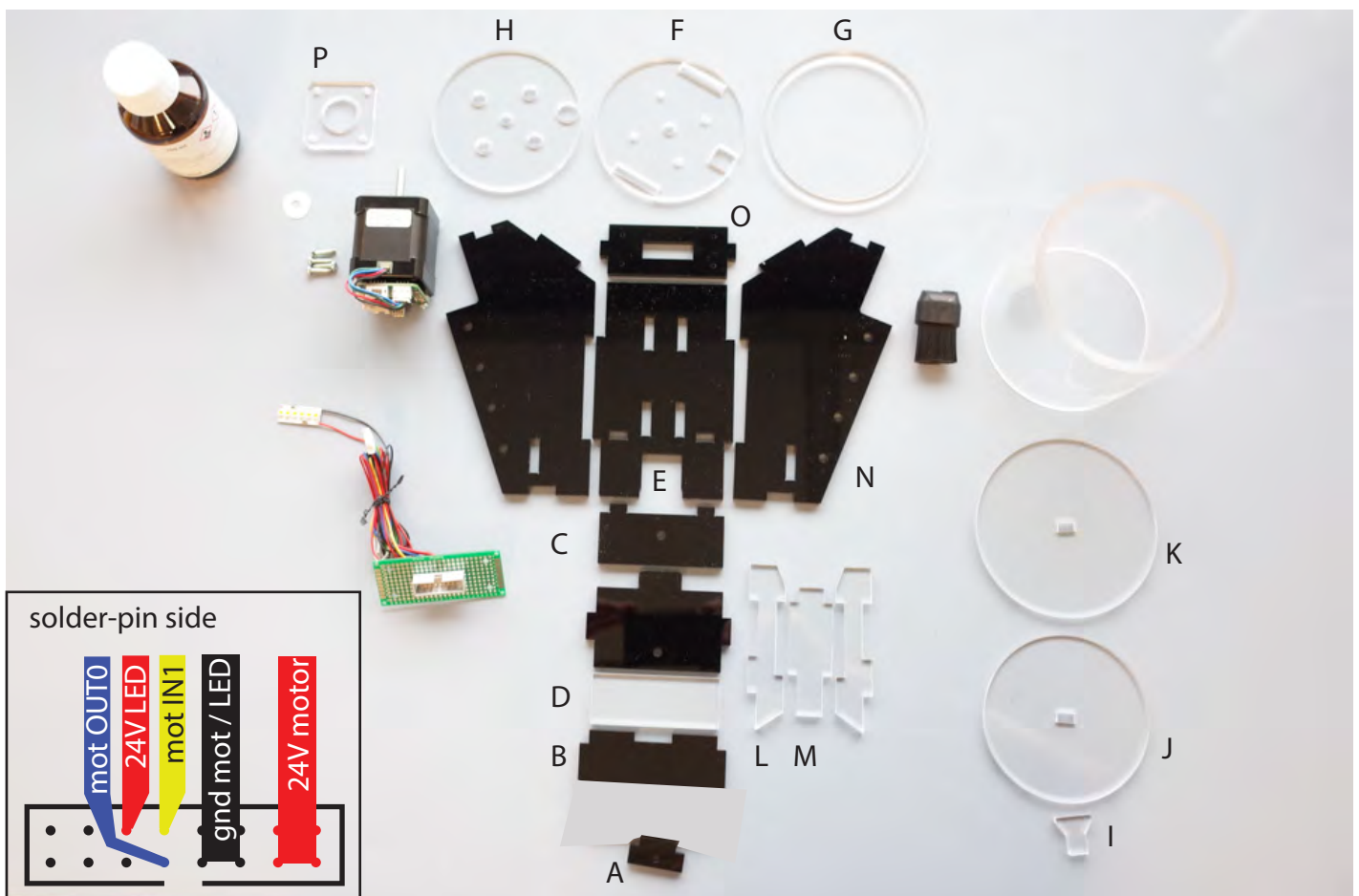

# Assembly

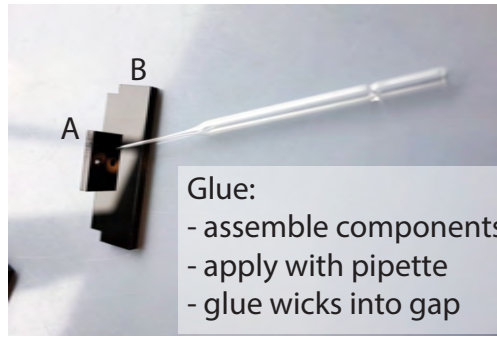
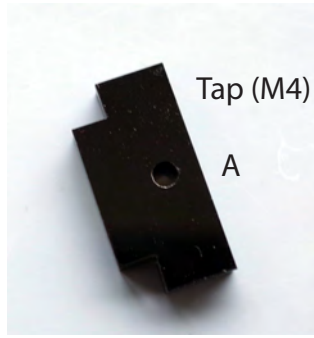

Glue:  
 - assemble components  
 - apply with pipette  
 - glue wicks into gap

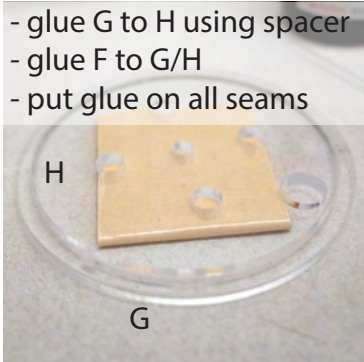
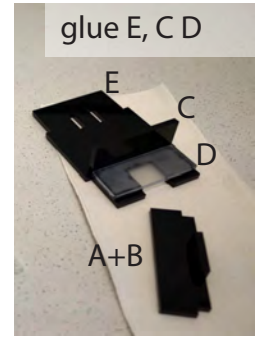

- glue G to H using spacer  
 - glue F to G/H  
 - put glue on all seams

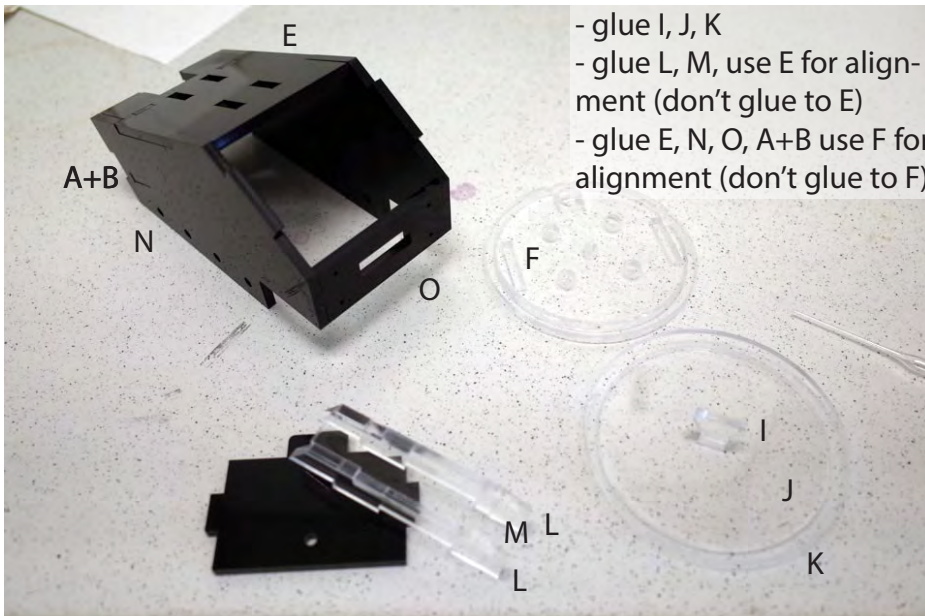
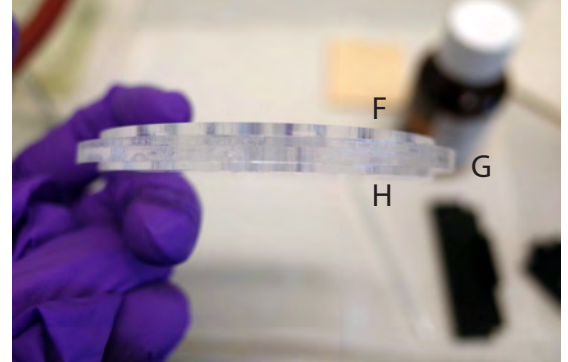
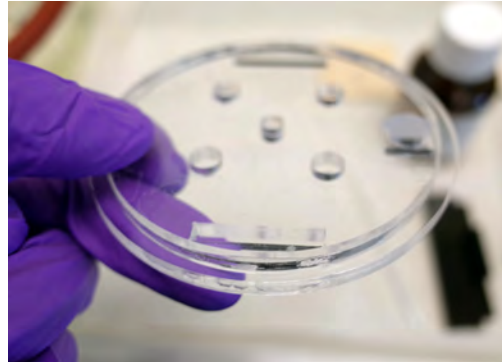

- glue I, J, K  
 - glue L, M, use E for alignment (don't glue to E)  
 - glue E, N, O, A+B use F for alignment (don't glue to F)

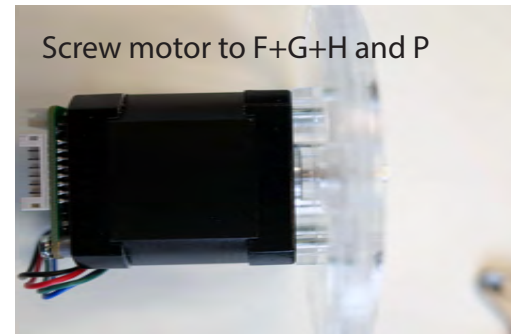

Screw motor to F+G+H and P

attach circuit-board with screws  
 gap in socket facing down

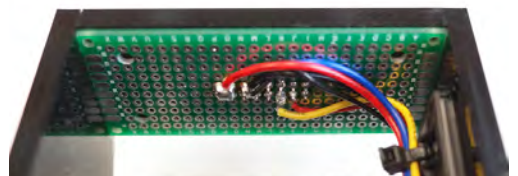

- push motor assembly to base  
 - add paper spacer to motor  
 - push rotating disc to motor (might have to widen cut-out)  
 - push pipe to assembly  
 - attach brush to pipe  
 - screw in front panel

Transparent, 5 mm

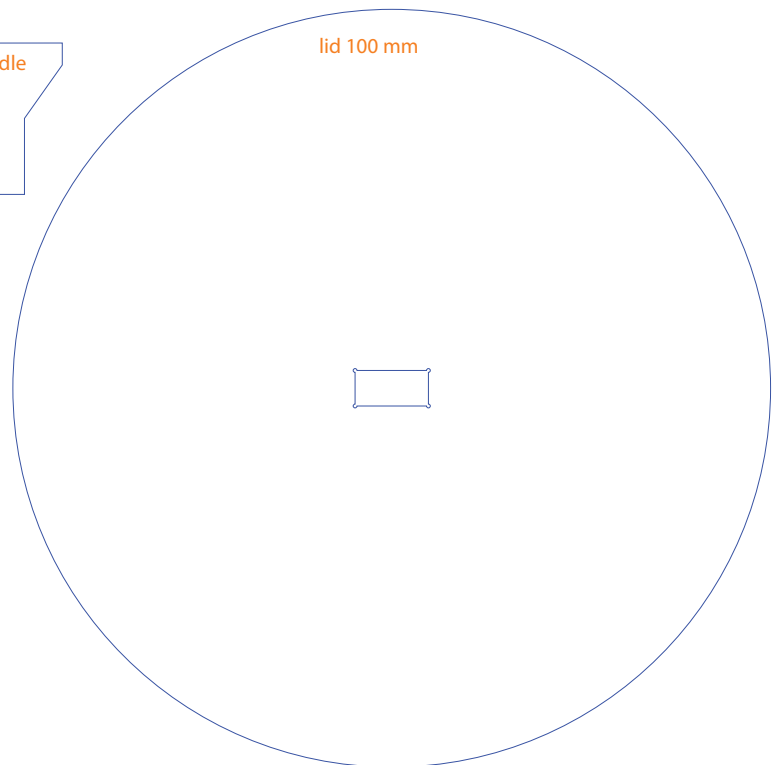
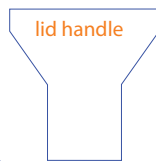
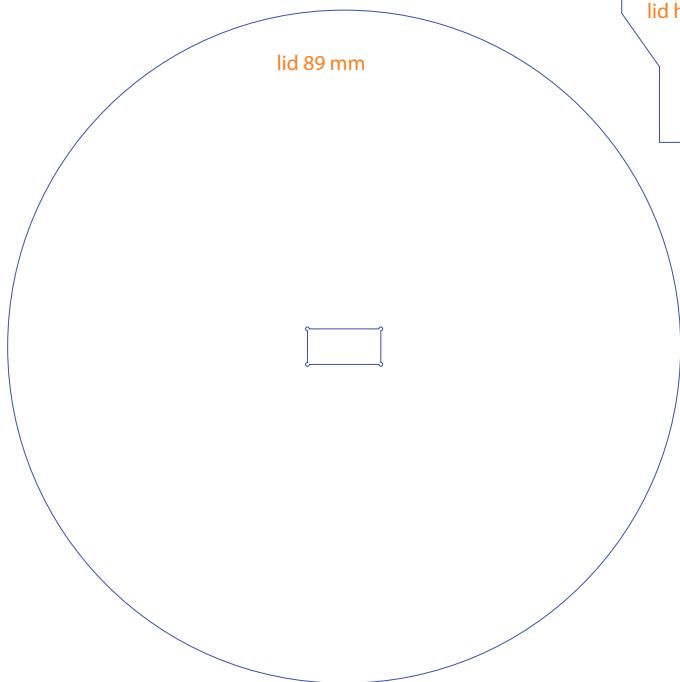
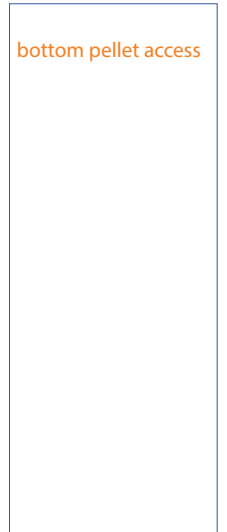
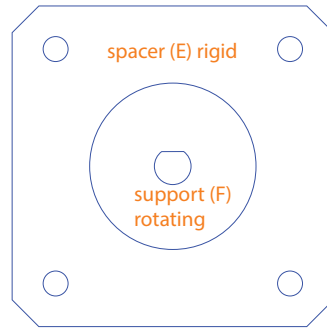
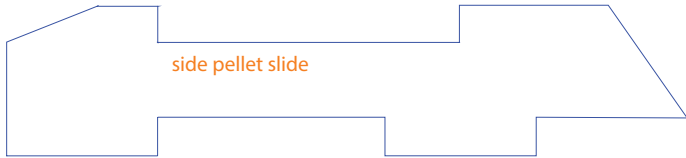
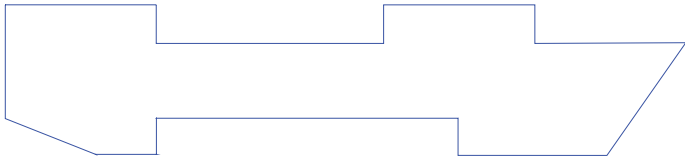
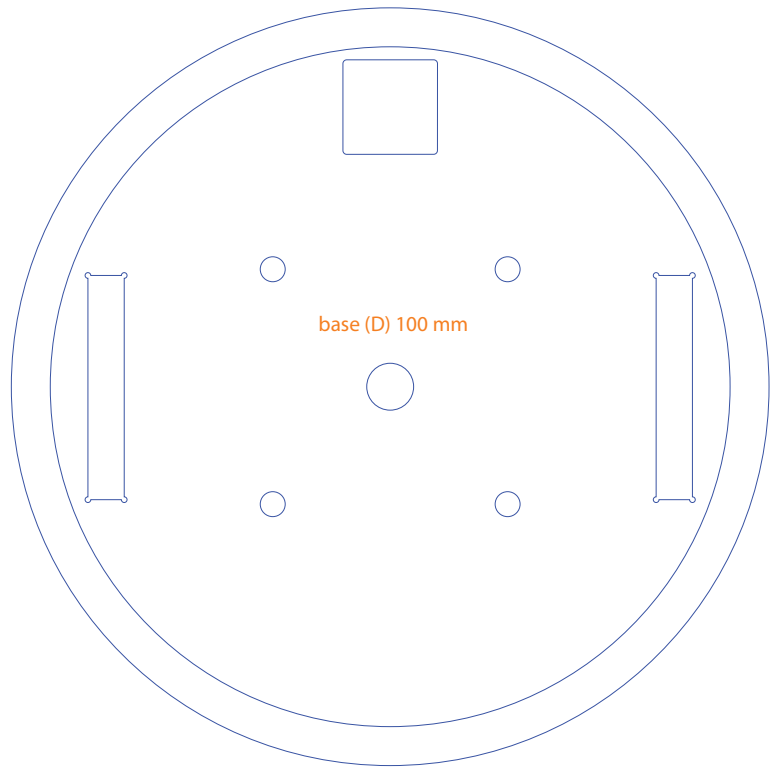
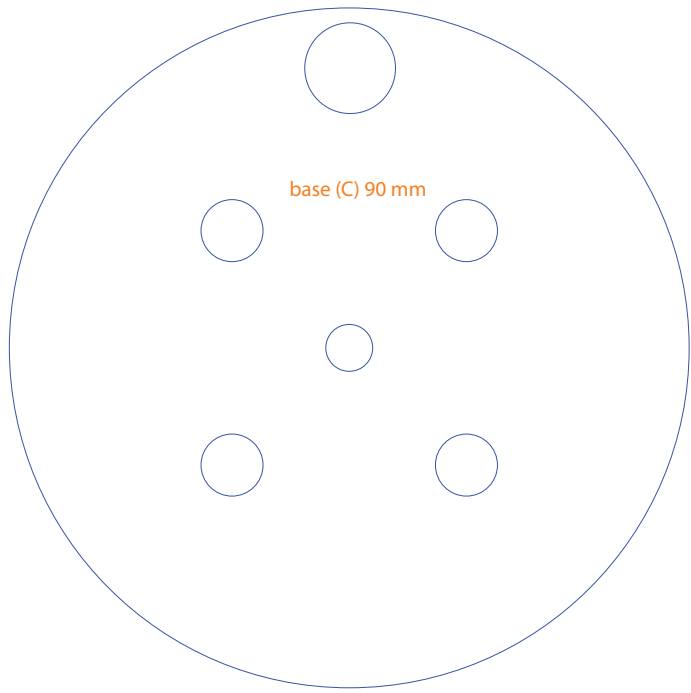

Black, 5 mm

side panel

accept LED shelf

mount

front

rear, accept 16pin socket

[747422-05]

[407827-05 different holes]

Lock front

LED shelf

LED back

accept LED back

accept pellet slide

[xxx]



# Transparent, 5 mm

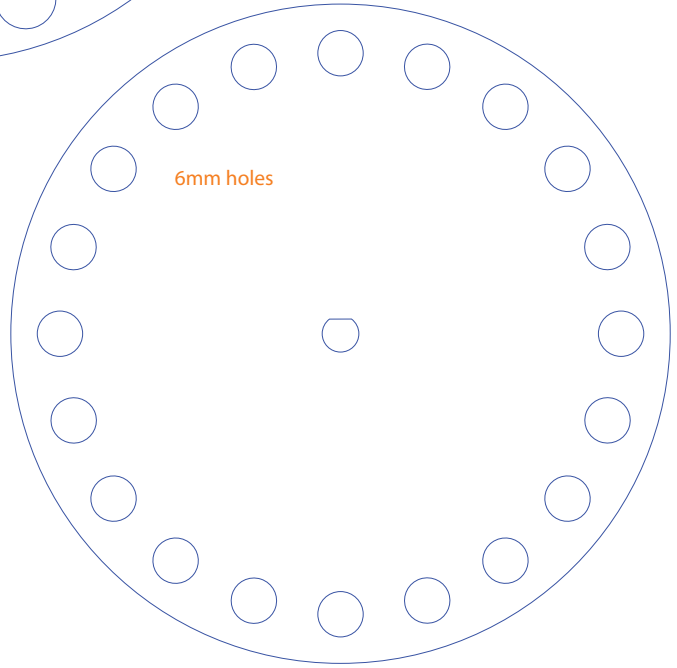
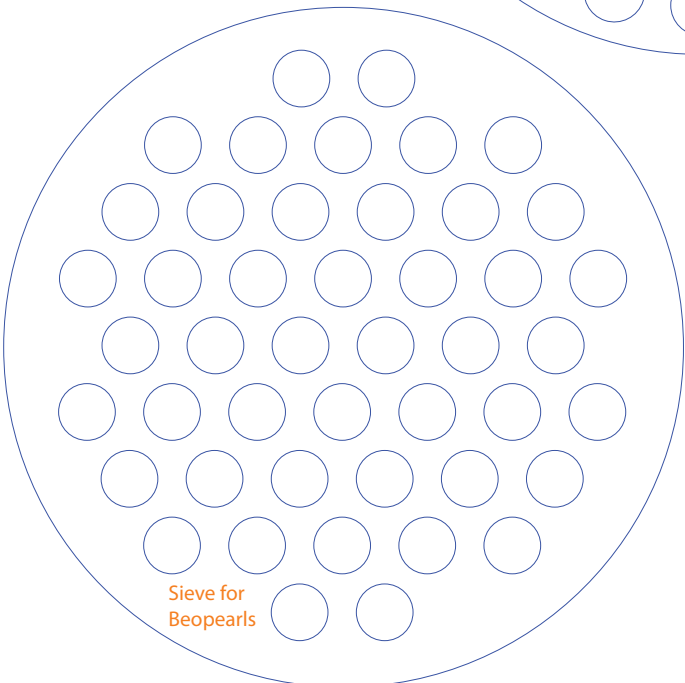
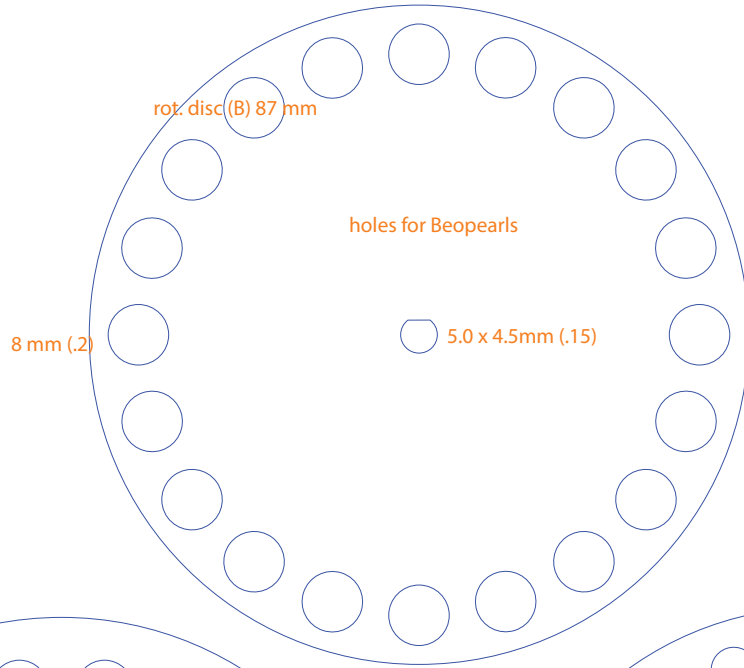

Transparent, 4 mm

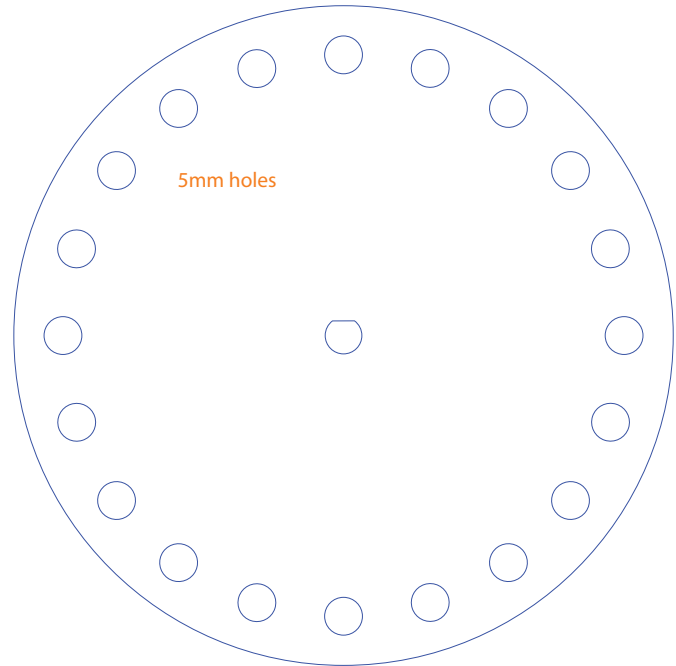
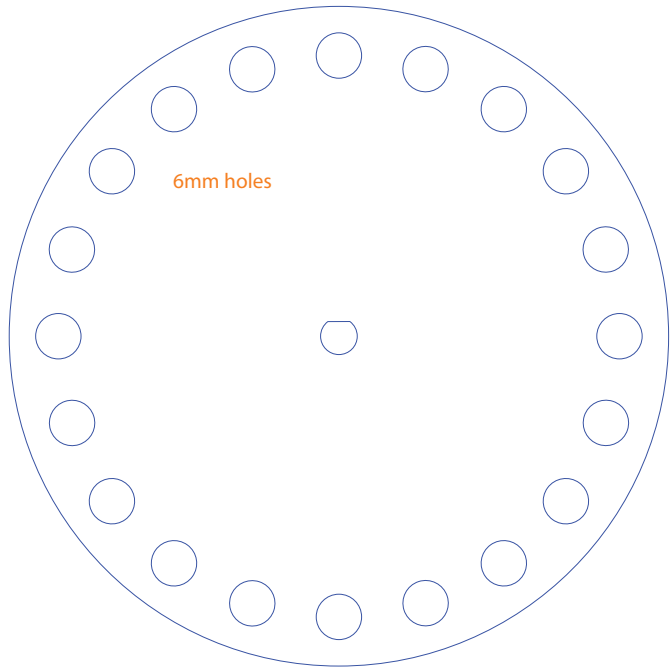



Transparent, 3 mm

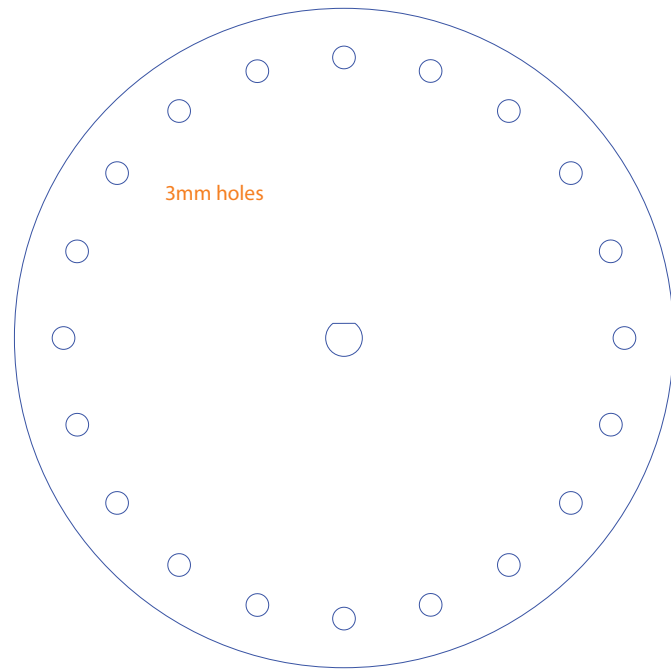
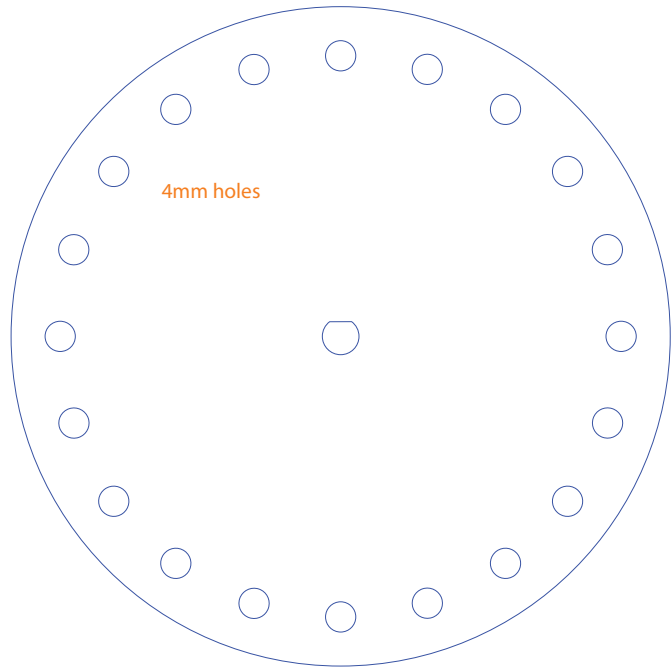

# Transparent opaque, 5mm



bottom pellet access